

FORM NO 1.

B-23-148?
Proprietors Land
a corner
near Dunlaps

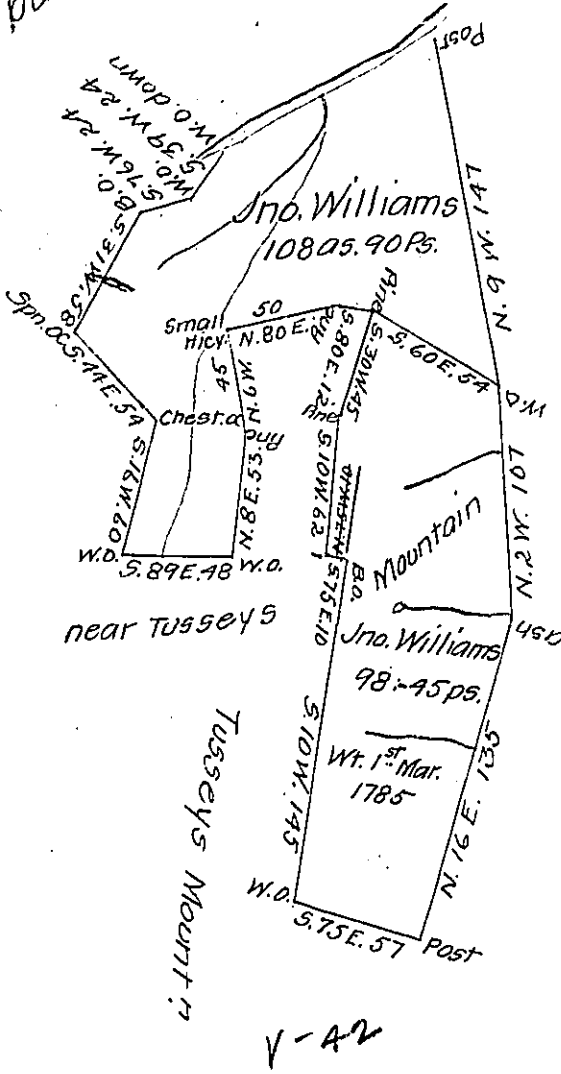

Courses & Distances up
the Run from the Post to
the W.O. now Down

S. 65 W. 33
S. 57 W. 48
S. 60 W. 19
100

108 + 90 -
98 + 45 -
206 + 135 -

A Draught of a tract of Land situate at the Foot of Tusseys
Mountain in Huntingdon Township & County containing 108 as 90 Ps.
& the Usual Allowance of Six per Cent for Roads Surveyed the 15th
Day of May 1788 in pursuance of a Warrant dated the 5th Day of
Septem^r 1786

John Canan D.S.

To John Lukens Esqr. S.G.

IN TESTIMONY that the above is a copy of the original remaining on file in
the Department of Internal Affairs of Pennsylvania, made
conformably to an Act of Assembly approved the 16th day of
February, 1833, I have hereunto set my Hand and caused
the Seal of said Department to be affixed at Harrisburg,
this second day of April 1907

Geo. B. Brown
Secretary of Internal Affairs.